

# Welcome to Control Play!



Enjoy your new Control Play console and the many benefits it brings to your business.

- Pre-loaded Control Play software and music video library
- Automatic content updates
- Pre-configured, plug and play
- Optional monitor display
- Optional Keyboard + mouse
- Unlimited tech support access



Control Play's team has done an audio/video system audit with you to ensure compatibility before this console was delivered. **All necessary adapters/cables are included in this box.**

Our Support Team is here to assist with each stage of setup and installation. if you need any assistance, please call us at: **1-866-896-3470 ext.1** or Chat: **controlplay.com/contact**

## Technical Requirements

### Audio

The console comes with a regular stereo, line-level audio output: 1/8" (3.5mm). This output connects directly to your mixer or sound equipment using an audio cable.

### Video

This console is equipped with HDMI and DisplayPort video outputs. S-Video, Component, and Composite video output requires a separate adapter. A video distribution system is recommended. Contact Control Play Support if you have any questions about your video connections.

### Internet

A direct, hard-wired connection from your router or modem is recommended for the most reliable performance. The internet connection download speed should be a minimum of 3 Mbps for optimal results.

### Electrical

To maintain warranty coverage for electronic components, ensure the console is plugged into a surge protection device. For maximum protection and reliability, an Uninterruptible Power Supply (UPS) is recommended—this can be purchased at any electronics or computer store.



# Setup and Installation

## 1. Unpack the Control Play Console and Cables



### Notes:

- Your Control Play Console can be placed horizontally or vertically
- If being placed in an AV Rack Shelf, we recommend 3U or more

1

### Console Dimensions:

Width: 10.75"

Height: 4"

Depth: 12" (allow 14" for cable connectors)

### BACK CONTROL PLAY CONSOLE

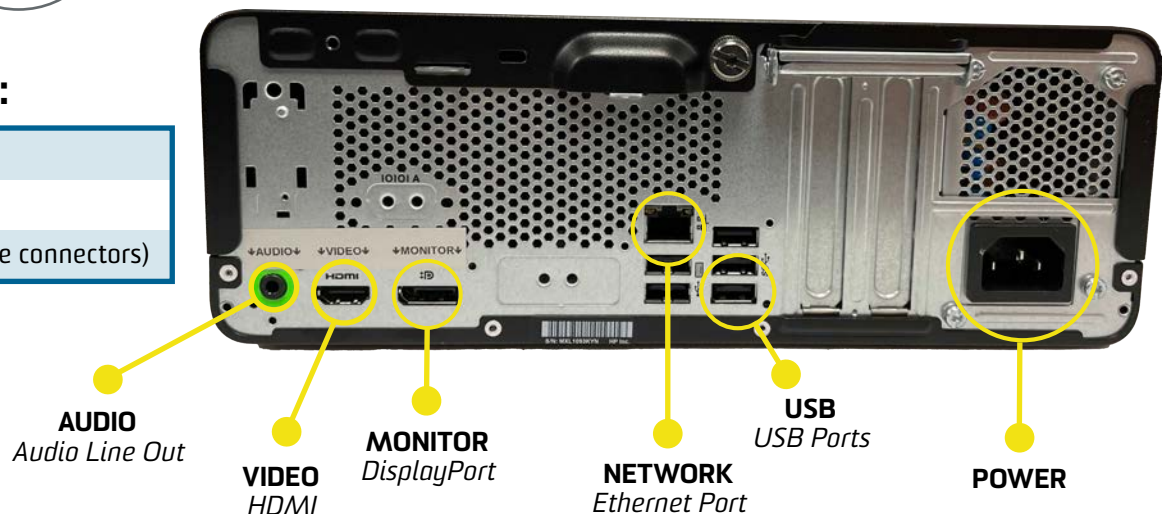

## 2. Connect Power

2

Power Cord



## 3. Connect Keyboard and Mouse (OPTIONAL)

3

Keyboard



Mouse

4

## 4. Connect sound system

### Option #1- Analog Audio

Audio is sent through 1/8" line out jack

### Option #2- Digital HDMI Audio

Audio is sent through HDMI

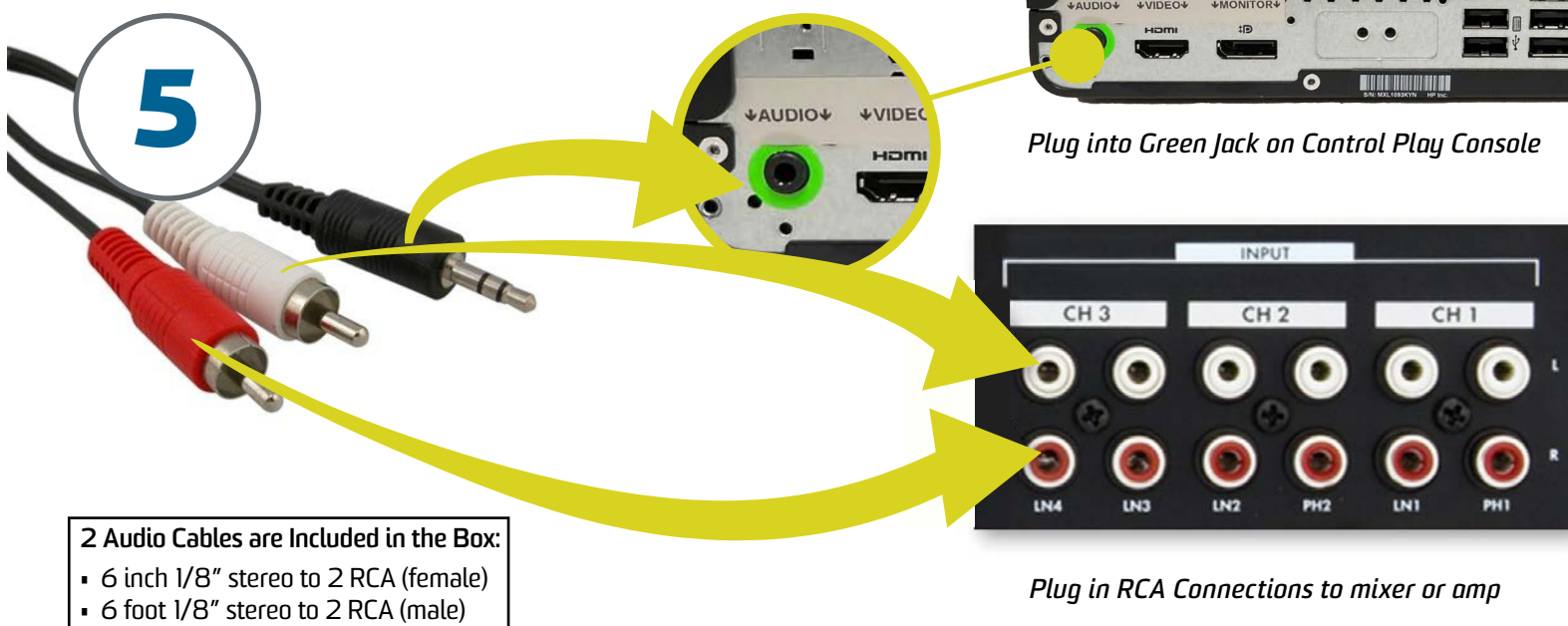

## Optional Audio Upgrades

Contact our Support Team to inquire about upgrades

### DIGITAL & ANALOG OUTPUT

High End USB DAC  
AudioQuest DragonFly RED



### XLR OUTPUT

Peavey USB-P  
Sound Card



## 5. Connect Video System

Music videos will show on  
TV or Projector screens

6

HDMI Cable

HDMI Output



HDMI

Connect HDMI to your Splitter/ Matrix / Extender or directly to a TV



### TIP:

We recommend a maximum length of 12 ft.  
between the console and HDMI splitter or  
HDMI matrix, unless using an extender.

### LEGACY VIDEO CONNECTIONS

Legacy video connections are supported with an  
additional HDMI video adapter. Contact support  
if you require one of these connections:

COMPONENT



COMPOSITE



S-VIDEO



VGA



TV or Projector



## 6. Connect to a Network or Internet Connection

7

### Ethernet Cable

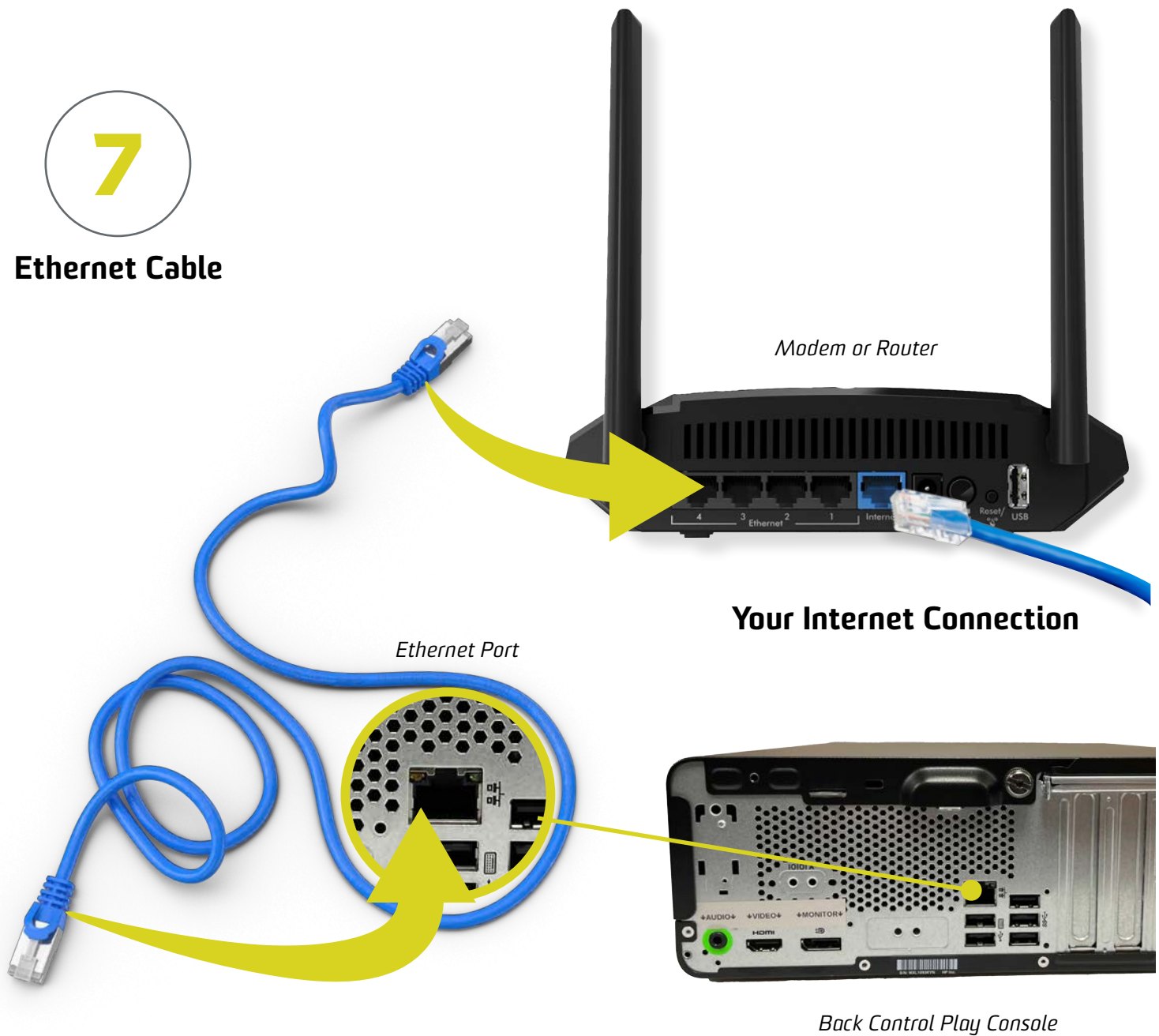

#### NOTES:

We don't recommend the use of WIFI as your network connection due to reliability. A USB WIFI adapter must be purchased separately to use WIFI.

## 7. Connect Monitor (Optional)

The Player User Interface will be displayed on the monitor after setup and when powered on.

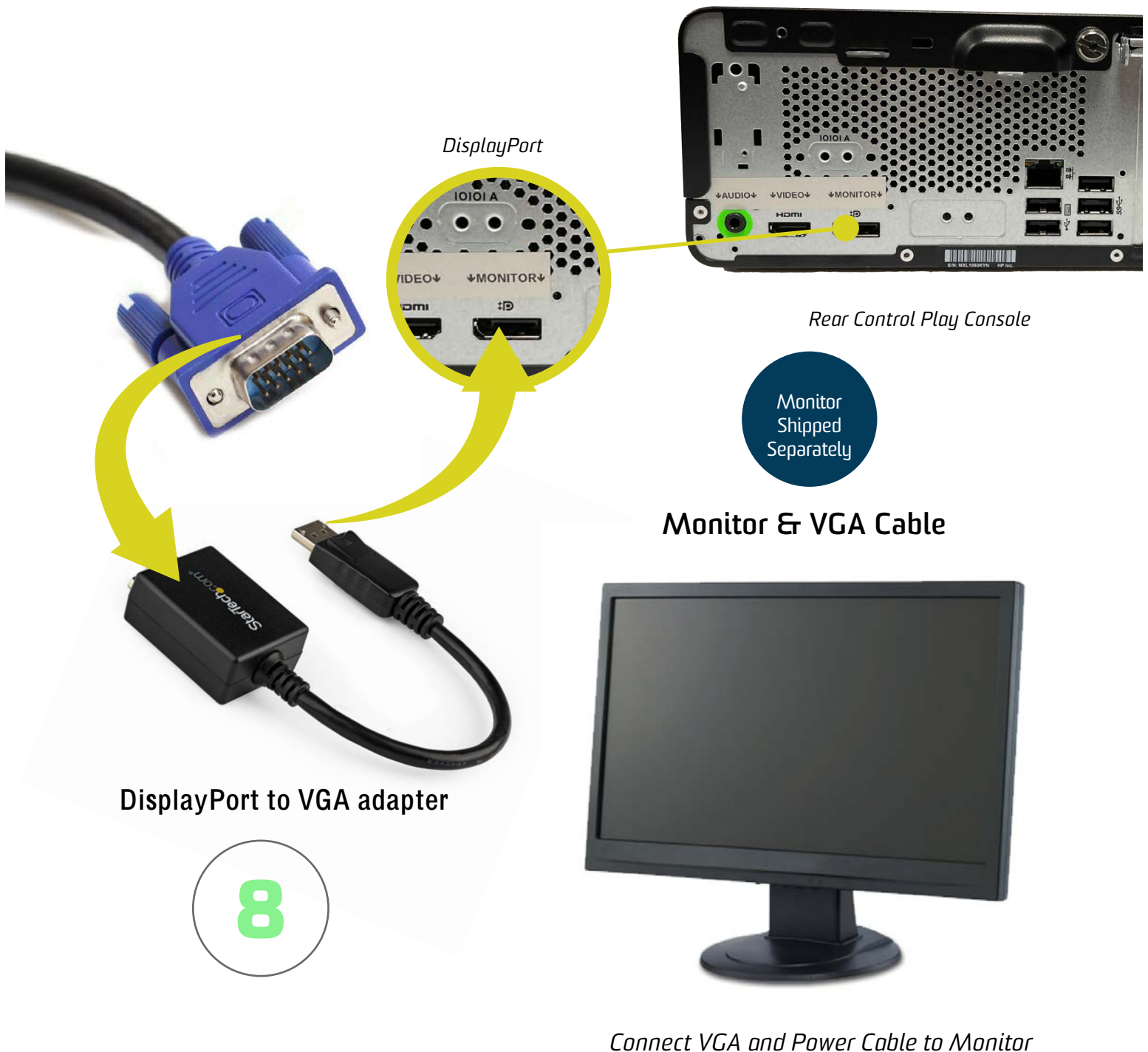

## 8. Turn on your Control Play Console with a press of the button!

The Music will start in 1-2 minutes



**PLEASE NOTE:** If the Player window loads on your TV/projector screens instead of your computer monitor, your displays need to be swapped.

Please call our Support Team to configure the displays:

**1-866-896-3470 ext. 1** or Chat: **[controlplay.com/contact](https://controlplay.com/contact)**

## TUTORIALS

Once you've finished setting up your Control Play Video Console, visit our online tutorials page to learn everything you need to know about the console, player, and more!

**[www.controlplay.com/tutorials](https://www.controlplay.com/tutorials)**